

Future Ready Classrooms

Lexington County School District One

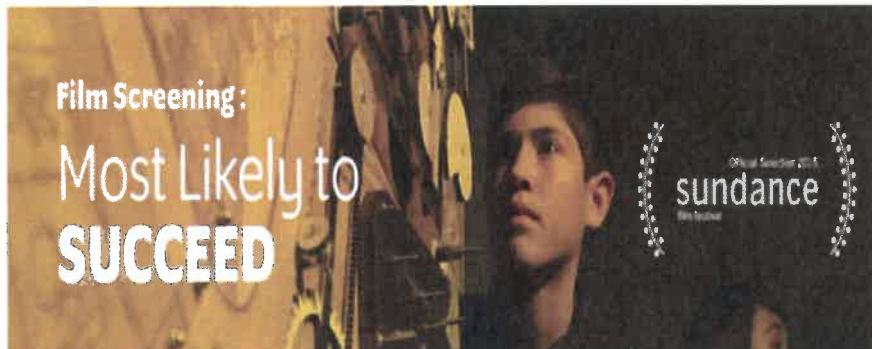

**Thursday, February 22
6:30 p.m.**

**Lexington Middle School's Theatre
White Knoll High School's Theater**



Empower each child to design the future.

The infographic is divided into two main sections. The top section, "TRADITIONAL CLASSROOM", shows a teacher at the front pointing to a "Math 1.01" board while students sit at desks. The bottom section, "DEEPER LEARNING CLASSROOM", shows students in various collaborative activities. Below this is a "CONSTRUCTION SITE" metaphor with six pillars: CONTENT, COMMUNICATIONS, COLLABORATION, CRITICAL THINKING, POSITIVE MINDSET, and LIFELONG LEARNING. A "50% LEASED" sign is also present. The bottom of the infographic includes the website "deeperlearning4all.org" and the hashtag "#deeperlearning".

TRADITIONAL CLASSROOM

Math 1.01

DEEPER LEARNING CLASSROOM

CONTENT
I've mastered and can use content knowledge (reading, math, science, etc.) in real-world situations.

COMMUNICATIONS
I can make presentations to explain my work and receive feedback constructively.

COLLABORATION
I can cooperate with others to solve problems together and learn from my peers.

CRITICAL THINKING
I apply reasoning and creativity to analyze evidence and solve complex problems.

POSITIVE MINDSET
I know if I work with others, parents and my teachers, I'll succeed.

LIFELONG LEARNING
I can negotiate, solve my problems, and ask for help when I need it.

CONSTRUCTION SITE

50% LEASED

deeperlearning4all.org #deeperlearning

Flashback: 2004

- The motion picture “Ray” was released in theatres.
- Tim McGraw released the single “Live Like You Were Dying”.
- The last episode of “Friends” aired on television.
- This is what a smartphone looked like...



Retro: 2004. Retro: 2004 - Mobile Gazette - Mobile Phone News, www.moblegazette.com/retro-2004-11x05x18.htm.

Flashback: Lexington One 2004

Desks for new schools looked like this...



“Future ready” classroom initiative goal

- Provide “future ready” classroom upgrades to all 2,036 classrooms in the district.
- Components - technology and furniture upgrades

Developing the Classroom Model

- Developed the model based on feedback from key stakeholders.
- Collaborative approach to gathering information.

Listen to the source...

- Began focus groups in early Fall 2017
- Discussed changing demands and advances in technology
- If we need to update our approach, what updates to structures and tools do we need to do the work?

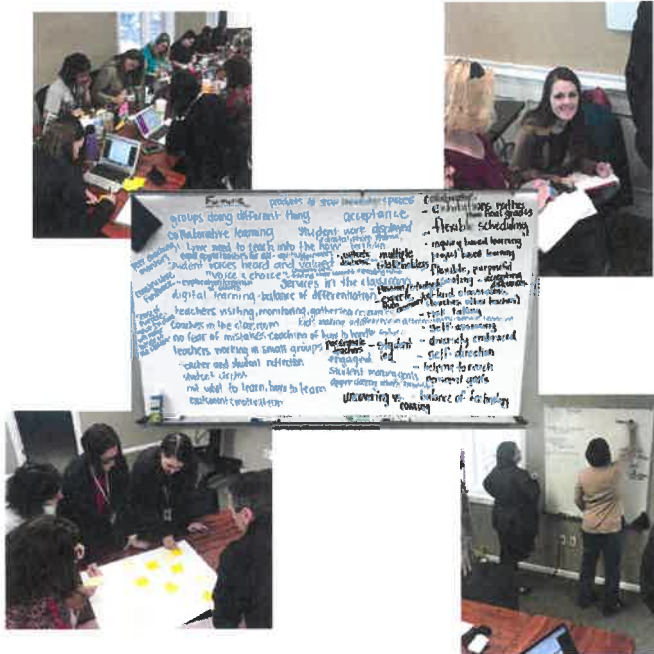

Results - feedback for a future ready classroom

- Flexible/movable furniture with varied seating options
- Maximize wall space with whiteboards for making thinking visible
- Mobile teacher workstations
- Additional electrical outlets/USB plugs
- Enhanced wireless infrastructure
- Multiple displays for use with multiple small groups
- Access to different computing devices and software
- Teleconferencing hardware/software for connecting with experts outside of the building
- Virtual reality hardware/software

Furniture evaluation

- Visited other districts with active learning classrooms
- Evaluated furniture from several manufacturers specializing in education
- Gathered feedback from our experts in the field

Form follows function



Furniture for future ready classrooms: grades K-2

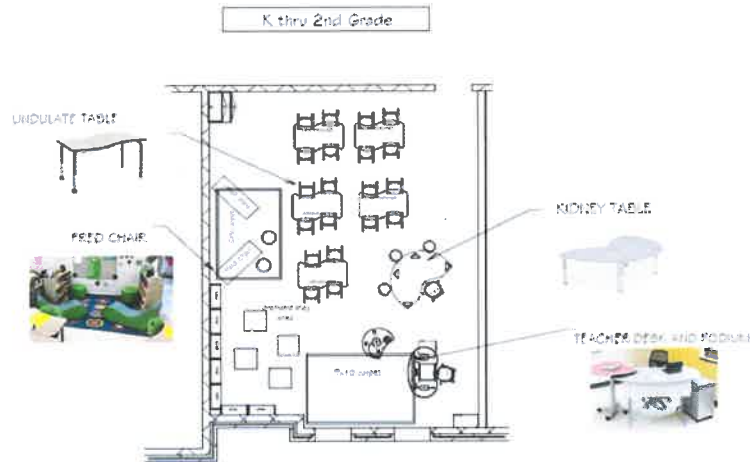

Furniture for future ready classrooms: grades 3-5

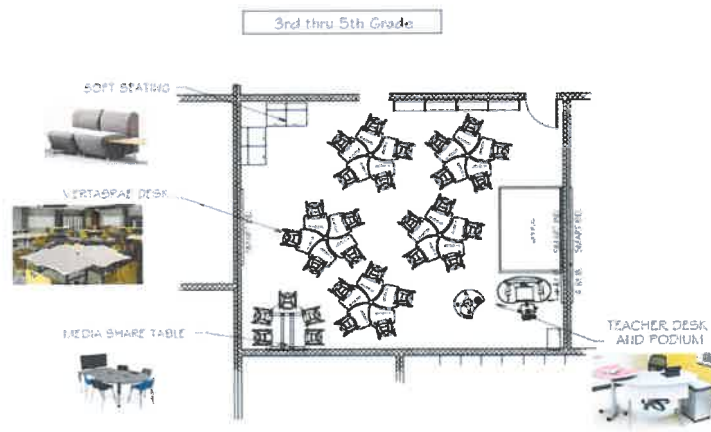

Furniture for future ready classrooms: grades 6 -8

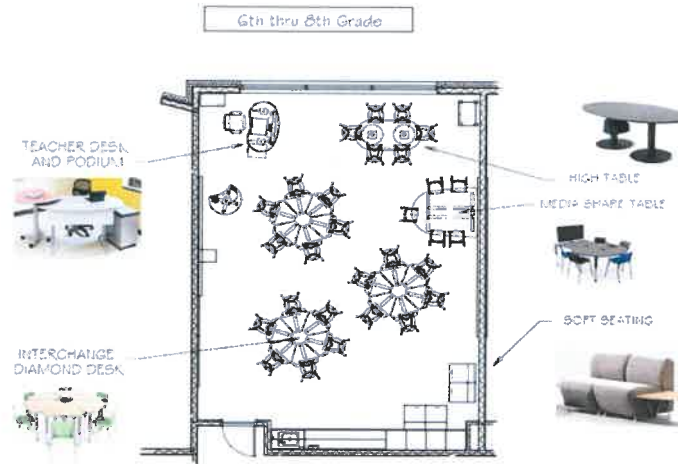

Furniture for future ready classrooms: grades 9-12

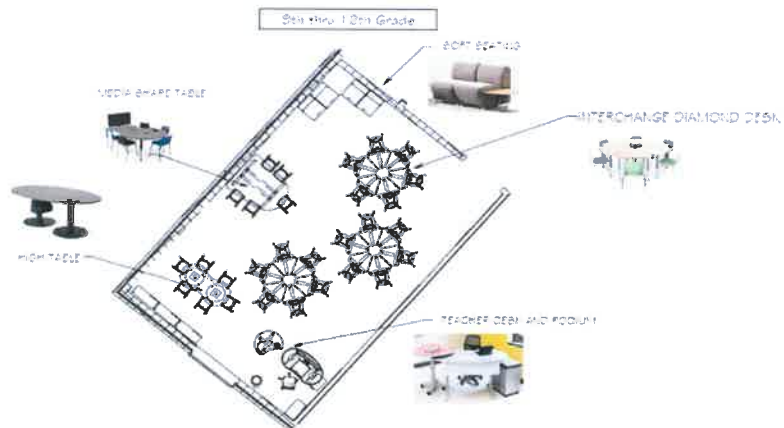

Additional furniture will be provided for:

- Cafeterias
- Learning Commons
- Office Areas

- Collaboration Spaces
- Makerspaces

Additional research on technology needs

- Regular meetings with principals to review technology needs
- Collaboration with Instructional Services

- Collaboration with security and construction
- Review of facility assessment with MB Kahn

Technology upgrades in response to feedback

- Classroom sound and display
- Labs and makerspaces
- Infrastructure and access points
- Safety and security

- Signage
- PA systems
- Theaters/cafeteriums
- Device refresh - Teacher/Student

Summary of technology and furniture for upgrades for a future ready district

Future Ready Technology
\$35,000,000

Furniture Needs
\$20,000,000

Total
\$55,000,000

Questions

Stakeholder Feedback

April 19, 2018

Carolina Springs Elementary

Recommendations

- Outside storage/equipment building
- Extend bus canopy
- Repair erosion control issues
- Replace folding partition
- Replace multi-purpose room flooring
- Paint corridors
- Replace water heater
- Secure entry upgrades
- Add exterior hardscaping
- Furniture upgrades
- Technology upgrades

Stakeholder Feedback

- **Bus loop upgrades**
- **Exterior upgrades/landscaping**
- **Security upgrades**
- **Technology upgrades**
- **Furniture upgrades**

- Fencing around perimeter
- Additional classroom space
- Update and add to existing playground

Carolina Springs Middle

Recommendations

- Classroom addition (6)
- Outside storage/equipment building
- Bus canopy improvements
- Car lane widening
- Fire alarm system replacement
- Upgrade cafeteria lighting
- Secure entry upgrades
- Furniture upgrades
- Technology upgrades

Stakeholder Feedback

- **Classroom addition**
- **Technology upgrades**
- **Furniture upgrades**

- Larger commons area
- Outdoor education area
- Athletic facility improvements
- Expanded parking area

Deerfield Elementary

Recommendations

- Secure entry upgrades
- Furniture upgrades
- Technology upgrades

Stakeholder Feedback

- **Secure entrance**
- **Technology upgrades**
- **Furniture upgrades**

- Additional classroom space in the next 5 years
- Additional PE space (room for 2 classes)
- Security alarm system

Forts Pond Elementary

Recommendations

- Classroom addition (4)
- Exterior storage/equipment building
- Replace folding partition
- Replace multi-purpose room flooring
- Add exterior lighting in front parking area
- Secure entry upgrades
- Furniture upgrades
- Technology upgrades

Stakeholder Feedback

- **Additional classrooms**
- **Safety and security upgrades**
- **Exterior storage building**
- **Furniture updates**
- **Flooring in all purpose room**
- **Technology upgrades**
- **Furniture upgrades**

Gilbert Elementary

Recommendations

- Replace and relocate GES

Stakeholder Feedback

- All needs addressed

Gilbert High

Recommendations

- Performing arts center
- Weight/wrestling rooms
- Equipment building at track
- Replace miscellaneous flooring
- Interior/exterior painting
- Add school store
- Add window to chorus room
- Water heaters replacement
- Replace fire alarm system
- Upgrade interior/exterior lighting
- Secure entry upgrades
- Add exterior hardscaping
- Furniture upgrades
- Technology upgrades

Stakeholder Feedback

- **Wrestling/weight room**
- **Gilbert performing arts center**
- **Equipment building at track**
- **Furniture upgrades**
- **Technology upgrades**

- Stadium improvements (pressbox, booster seating, brick fencing, concession stand under pressbox)

Gilbert Middle

Recommendations

- Classroom addition (4)
- Outside storage/equipment building
- Bus canopy improvements
- Car lane widening
- Fire alarm system replacement
- Upgrade cafeteria lighting
- Secure entry upgrades
- Furniture upgrades
- Technology upgrades

Stakeholder Feedback

- **Orchestra storage**
- **Additional classrooms**
- **Parking/traffic improvements**
- **Technology upgrades**
- **Furniture upgrades**

- Athletic facility improvements
- Larger learning commons

Gilbert Primary

Recommendations

- Outside storage/equipment building
- Interior painting
- Add canopies and walking track
- Re-route driveway/parking
- Replace HVAC controls, water heater and exhaust hood
- ADA upgrades to restrooms
- Upgrade interior/exterior lighting
- Secure entry upgrades
- Add exterior hardscaping
- Replace doors, hardware and add directional signage
- Furniture upgrades
- Technology upgrades

Stakeholder Feedback

- **Carline/parking/traffic flow improvements**
- **Walking track**
- **Secure entry upgrades**
- **Doors and hardware replaced**
- **Improve ADA accessibility**
- **Parking lot improvements (asphalt)**
- **Technology upgrades**
- **Furniture upgrades**

- Playground drainage issues
- Collaborative space

Lake Murray Elementary

Recommendations

- Outside storage/equipment building
- Interior/exterior painting
- Replace roof
- Upgrade cafeteria and stage lighting
- Add terraced wall at playground
- Secure entry upgrades
- ADA upgrades to restrooms and playground equipment
- Upgrade exterior lighting and hardscaping
- Furniture upgrades
- Technology upgrades

Stakeholder Feedback

- **Security improvements**
- **Playground improvements**
- **Replace roof**
- **Technology upgrades**
- **Furniture upgrades**

- HVAC repairs
- Cafeteria renovation for capacity
- Sports complex
- Perimeter fencing

Lexington Elementary

Recommendations

- Outside storage/equipment building
- Replace miscellaneous ceiling tiles, vinyl base, casework and flooring
- Buildings that have exceeded life expectancy should be removed
- Resurface asphalt and add new stacking lane
- Upgrade exterior lighting
- Add rubber stair treads
- Replace doors and hardware
- Secure entry upgrades
- Furniture upgrades
- Technology upgrades

Stakeholder Feedback

- **Safety Improvements**
- **Remove older buildings**
- **Interior and exterior doors replaced**
- **Traffic flow improvements**
- **Technology upgrades**
- **Furniture upgrades**

- All ceiling tiles replaced throughout the building
- Remove and upgrade awnings and covered walkways around campus

Lexington High

Recommendations

- Athletic storage buildings (2)
- Carpet replacement
- Interior finish upgrades
- Parking/drives improvements
- Roof replacement
- Water heater replacement
- Replace directional signage in A-D wings
- Secure entry upgrades
- Furniture upgrades
- Technology upgrades

Stakeholder Feedback

- **Furniture upgrades**
- **Roof replacement**
- **Parking lot improvements**
- **Learning Commons upgrades**
- **Security upgrades**
- **Technology upgrades**

- 2 large collaborative spaces
- Landscaping/hardscaping around athletic fields
- Turf athletic field
- Gravel driveway behind the band room

Lexington Middle

Recommendations

- Replace and relocate this school

Stakeholder Feedback

- All needs addressed

Lexington Technology Center

Recommendations

- Replace miscellaneous flooring
- Replace older windows
- Add canopies
- Overlay asphalt at front drive
- Exterior painting
- Renovate locker rooms
- ADA restroom upgrades
- Replace roll-up doors at labs
- Secure entry upgrades
- Furniture upgrades
- Technology upgrades

Stakeholder Feedback

- **Parking lot improvements**
- **Locker room updates/improvements**
- **Security improvements**
- **Technology upgrades**
- **Furniture upgrades**
- Additional classroom space (10+)

Meadow Glen Elementary

Recommendations

- Outdoor storage/equipment building
- Secure entry upgrades
- Furniture upgrades
- Technology upgrades

Stakeholder Feedback

- **Technology upgrades**
- **Security upgrades**
- **Improve book collection in learning commons**
- **Furniture upgrades**
- **Address capacity issues**

Meadow Glen Middle

Recommendations

- Outdoor storage/equipment building
- Secure entry upgrades
- Furniture upgrades
- Technology upgrades

Stakeholder Feedback

- **Address capacity issues**
- **Technology upgrades**
- **Furniture upgrades**
- Traffic flow improvements on Ginny Lane
- Improve car stacking

Midway Elementary

Recommendations

- Outside storage/equipment building
- Secure entry vestibule
- Parking/drive repair
- General interior finish upgrades
- Upgrade computer labs for more flexibility
- Install new fire alarm system
- Upgrade interior/exterior lighting
- Exterior window replacement
- Secure entry upgrades
- Furniture upgrades
- Technology upgrades

Stakeholder Feedback

- **Secured entrance**
- **Technology upgrades**
- **Playground upgrades**
- **Furniture upgrades**
- Additional PE room
- Upgrade kitchen equipment

New Providence Elementary

Recommendations

- Outside storage/equipment building
- Replace folding partition
- Replace multipurpose room carpet to sports floor
- Repaint corridors
- Replace interior lighting controls
- Secure entry upgrades
- Furniture upgrades
- Technology upgrades

Stakeholder Feedback

- **Secured entrance**
- **Technology upgrades**
- **Furniture upgrades**
- Classroom addition
- Improve car drop-off/pick-up lane

Oak Grove Elementary

Recommendations

- Classroom/Fine Arts addition
- Additional parking and fire lane
- Student restroom renovations
- General interior finishes upgrades
- Exterior building improvements
- New fire sprinkler and fire alarm systems
- Exterior security lighting upgrades
- Secure entry upgrades
- Outdoor storage/equipment building
- Furniture upgrades
- Technology upgrades

Stakeholder Feedback

- **Outdoor storage building**
- **New instructional wing**
- **Parking lot and exterior lighting improvements**
- **Exterior building improvements**
- **Perimeter fencing**
- **Replace carpet in multipurpose room with sports floor**

- Bus loop improvements
- Door hardware needs to be ADA compliant
- Add breezeway from gym to kindergarten hall

Pelion Elementary

Recommendations

- Outdoor storage/equipment building
- Ceiling and lighting replacement
- General interior finishes upgrades
- Playground improvements
- Replace kitchen equipment (portion)
- Replace roof at 2001 addition
- Replace interior lighting
- Secure entry upgrades
- Furniture upgrades
- Technology upgrades

Stakeholder Feedback

- **Technology upgrades**
- **Furniture upgrades**
- **Security upgrades**
- **New playground**
- **Lighting upgrades and interior finishes upgrades**

Pelion High

Recommendations

- Locker/restroom/concession building at track
- Visitor locker room (at stadium)
- Weight/wrestling rooms
- Add school store in commons area
- Replace miscellaneous flooring
- Upgrade sound in gym and auditorium
- Replace emergency restrike in auditorium
- Upgrade interior lighting
- Secure entry upgrades
- Furniture upgrades
- Technology upgrades

Stakeholder Feedback

- **Learning commons upgrades**
- **New locker rooms (track and stadium)**
- **Wrestling room**
- **Door upgrades**
- **Track facilities upgrades**
- **Technology upgrades**
- **Furniture upgrades**

- Parking lot upgrades
- Exterior lighting upgrades
- Sports turf stadium

Pelion Middle

Recommendations

- Replace and relocate this school

Stakeholder Feedback

- All needs addressed

Pleasant Hill Elementary

Recommendations

- Outside storage/equipment building
- General interior finishes upgrades
- Add loading dock at kitchen
- Replace folding partition
- Secure entry upgrades
- Furniture upgrades
- Technology upgrades

Stakeholder Feedback

- **Technology upgrades**
- **Furniture upgrades**
- **Safety upgrades**
- **Interior finish upgrades**
- **New school to help with growth**
- **Loading dock at kitchen**
- **Storage/equipment building**
- **Equipment refresh in fine arts and physical education**

- Improved/larger PE and cafeteria space for family events
- Replace PE floor

Pleasant Hill Middle

Recommendations

- Outdoor storage/equipment building
- Additional canopy
- Add exterior hardscaping
- Upgrade interior lighting
- Secure entry upgrades
- Furniture upgrades
- Technology upgrades

Stakeholder Feedback

- **Storage/equipment building**
- **Additional canopy**
- **Cafeteria furniture upgrades**
- **Technology upgrades**
- **Furniture upgrades**

- Additional classrooms
- Practice gym
- Another drop off/pick up location for car riders

Red Bank Elementary

Recommendations

- Outside storage/equipment building
- Student restroom renovations
- Interior finish upgrades
- Playground improvements
- Kitchen hood/freezer/cooler/serving lines replacement
- Secure entry upgrades
- Furniture upgrades
- Technology upgrades

Stakeholder Feedback

- Security upgrades
- HVAC system improvements
- Interior finish upgrades
- Student restroom upgrades
- Technology upgrades
- Furniture upgrades

- Address student/teacher ratios
- Fencing around facility
- New carpet/rugs in classrooms
- Window replacement
- Hardscaping/sidewalks

River Bluff High

Recommendations

- Athletic storage building
- Student canopy improvements
- Concrete at islands
- Replace fire lane with concrete
- Secure entry upgrades
- Furniture upgrades
- Technology upgrades

Stakeholder Feedback

- Technology upgrades
- Furniture upgrades

- Additional student parking
- Classroom addition
- Visitor building for the stadium
- Consider removing some of the windows

Rocky Creek Elementary

Recommendations

- Secure entry upgrades
- Furniture upgrades
- Technology upgrades

Stakeholder Feedback

- **Technology upgrades**
- **Furniture upgrades**
- **Security upgrades**
- **Cafeteria furniture to accommodate growth**

- Additional classroom space
- Additional PE space
- Study traffic flow
- Additional playground equipment

Rosenwald Community Learning Center

Recommendations

- Walk in cooler/freezer
- Replace miscellaneous ceiling tiles
- Roof replacement
- Add new serving line
- Secure entry upgrades
- Furniture upgrades
- Technology upgrades

Stakeholder Feedback

- **Technology upgrades**
- **Furniture upgrades**

Saxe Gotha Elementary

Recommendations

- Storage equipment building
- Window replacement
- General interior finishes upgrades
- Dishwasher and serving lines replacement
- Secure entry upgrades
- Furniture upgrades
- Technology upgrades

Stakeholder Feedback

- PA system replacement
- Security upgrades
- Window replacement
- Interior upgrades
- Parking lot improvements
- Furniture upgrades
- Storage/equipment building
- HVAC improvements
- Technology upgrades
- Furniture upgrades

- PE facility upgrades

White Knoll Elementary

Recommendations

- Kindergarten classrooms (4)
- Outside storage/equipment building
- Window replacement
- Interior finish upgrades
- Bus drive improvements
- Playground improvements
- Replace fire alarm system
- Replace kitchen exhaust hood
- Secure entry upgrades
- Furniture upgrades
- Technology upgrades

Stakeholder Feedback

- Playground equipment replaced
- Technology upgrades
- Furniture upgrades
- Security upgrades
- Carpet replacement
- Additional classrooms
- Interior finish improvements
- Traffic flow improvements
- Replace cafeteria stage curtain

- Covered walkway for carline

White Knoll High

Recommendations

- Classroom addition (32)
- Performing arts center
- Replace miscellaneous flooring
- Replace ceiling tiles in cafeteria and gymnasium lobby
- Replace roof, HVAC system and water heater
- Repurpose existing auditorium
- Add site security fencing
- Secure entry upgrades
- Furniture upgrades
- Technology upgrades

Stakeholder Feedback

- **Classroom addition (32)**
- **Performing arts center**
- **Mechanical systems replaced**
- **Security upgrades**
- **Technology upgrades**
- **Furniture upgrades**
- **Gym renovations**

- Improve traffic flow

White Knoll Middle

Recommendations

- Storage/equipment building (include parking)
- Interior finish upgrades
- Bus canopy improvements
- Upgrade exterior/interior lighting
- Secure entry vestibule and replace panic hardware on exterior doors.
- Replace exit lights
- ADA upgrades to group toilets
- Secure entry upgrades
- Furniture upgrades
- Technology upgrades

Stakeholder Feedback

- **Storage/equipment building**
- **Technology upgrades**
- **Furniture upgrades**
- **Security upgrades (including lighting)**
- **Secure entrance**
- **Interior finish upgrades**
- **Bus canopy**

- HVAC upgrades
- Replace gym bleachers
- Additional parking

Funding of the 2018 Bond Referendum

2008 Bond Referendum

- \$336 million dollars
- 5 schools
 - Lexington Attendance Area
 - 2 elementary schools, 1 middle school, 1 high school
 - White Knoll Attendance Area
 - 1 elementary school
- Renovations at 15 other district locations
- Technology/security upgrades across the district



2008 Bond Referendum

- Millage for debt service was 73.3 mills in 2008
- District agreed not to raise millage more than 12 mills to pay for the referendum
- After all projects were completed in 2015 the debt service millage was 71.3 mills
- Millage *decreased* by 2 mills

2018 Bond Referendum

- \$393 million currently proposed
 - New Schools - \$210 million
 - Additions - \$65 million
 - Renovations and Building Systems - \$45 million
 - Safety and Security - \$18 million
 - Furniture and Technology - \$55 million



2018 Bond Referendum

- The district would not increase the millage more than 19 mills to fund the referendum
- An increase of \$95 to homeowners assessed at \$100,000
- An increase of \$114 to businesses assessed at \$100,000
- Around half of the debt service millage is offset by our local one cent sales tax

Questions

